

# Standby Saver Instructions

The Standby Saver socket helps you avoid standby consumption by learning your remote control signal and controlling the appliances you plug in.

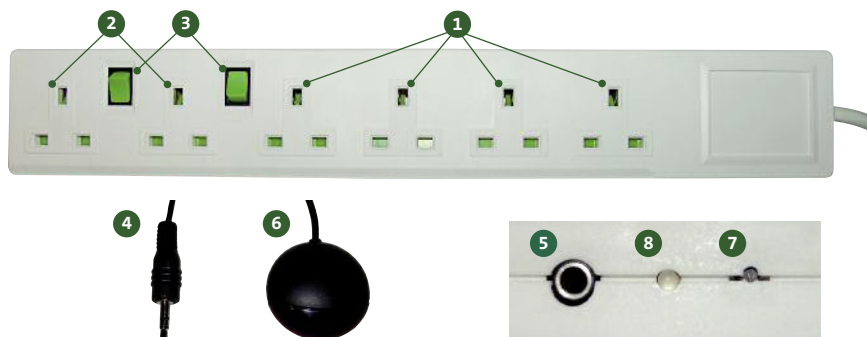

It may help to read through the instructions before setting up your Standby Saver.

- Switch off and unplug at the mains all the appliances you wish to plug into the Standby Saver unit.
- The appliances on which you can make standby savings should be plugged into the four sockets on the right (Item 1).
- The appliances which need to be on permanently, for example a video player with a clock, should be plugged into the two sockets on the left (Item 2) with the green switch (Item 3) in the “Mains” position. When everything else is powered down, these appliances will retain power.
- These two sockets can alternatively be used to power down extra appliances, if they are not required as a source of permanent power. To do this, the green switch must be in the “Standby” position.
- Plug the infrared sensor lead (Item 4) into the back of the Standby Saver (Item 5). The sensor (Item 6) should be placed in a position to receive a signal from your remote control.
- Plug your Standby Saver into the mains, and switch on at the mains.
- Choose the remote control you wish to use with the Standby Saver. The TV remote control is recommended.
- A few seconds after switching the Standby Saver on, use a non-metallic pointer to hold down the mode button at the back of Standby Saver (Item 7). After a few seconds the “Status” light on the back of the Standby Saver (Item 8) will shine red.

standby  
saver

- Aim the remote control at the infra-red sensor (Item 6) and press the button on your remote control that you wish to use to power down the appliances plugged into the Standby Saver. The standby button on your chosen remote control is recommended. Hold the button until the red "Status" light (Item 8) goes out. The light will flicker as the remote control signal is received - this is normal.
- After a few seconds the "Status" light will shine red again. Confirm your choice by pressing the same button on your remote control again. Hold the button until the red "Status" light (Item 8) goes out. Your chosen button is now the "off" button for the appliances plugged into the socket.
- After a few seconds the "Status" light will shine green. Press the button you wish to use to return power to the appliances. The light will flicker as the remote control signal is received, and then go out. You only need to do this once. The same button on your remote control can be used as the "on" and "off" button. Your chosen button is now the "on" button for appliances plugged into the socket.
- To test the learning process has worked, use your chosen 'off' button to power down the appliances you have plugged into the Standby Saver.
- Your chosen "on" button will now return power to these appliances.
- If you find that the Standby Saver has not learned the codes correctly, switch off the Standby Saver at the mains and repeat the process from plugging it into the mains.

## General Information

- The Standby Saver can be reprogrammed with new "on" and "off" buttons or using a new remote control by following instructions from Step 6.
- Other infrared signals may interfere with the learning process – try to set your Standby Saver up away from other remote controls and infrared signals.
- The Standby Saver will not respond to the remote control for a few seconds after appliances are switched "on" and "off", to protect your appliances.
- You will notice that under normal operation the "Status" light will light up when Standby Saver receives a remote control signal. This is normal.
- The Standby Saver will not respond to the remote control for 5 seconds after the appliances are switched "on" or "off".

**WARNING the Standby Saver unit has a maximum power rating of 240V AC 50Hz; do not connect more than 3,000 Watts.**

## Safety Standards

This product is compliant with all appropriate British and European safety standards.

